



Rosemount Rd, W3

Situated on the ever-popular Rosemont Road, this exceptionally spacious one-bedroom apartment spans approximately 850 sq ft and occupies the top floor of an impressive Victorian building. The property also enjoys a large private roof terrace overlooking the garden, measuring 16'3 x 8'8.

The flat offers excellent potential for someone wishing to add their own personal touch, as well as presenting an attractive opportunity for investors seeking a strong rental prospect. Further benefits include a separate kitchen, a brand-new lease, low maintenance costs, and no onward chain.

£400,000

- Huge one bedroom flat
- 850 sq ft in total
- Period conversion
- Top floor flat
- Separate kitchen
- Large roof terrace (16'3 x 8'7)
- No chain
- Potential to change layout
- Close to Elizabeth Line and other transport links
- Brand new lease

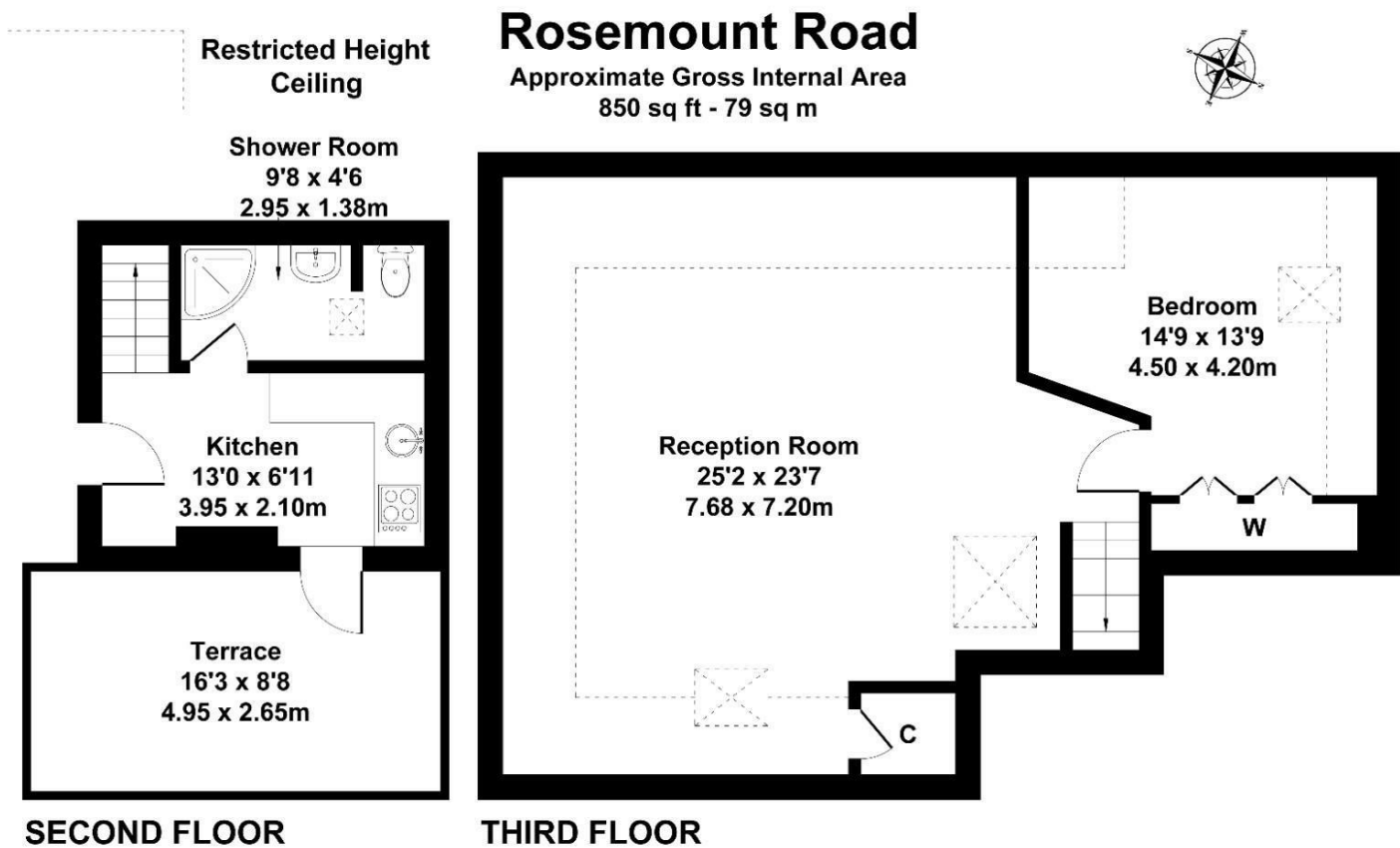

Not to Scale. Produced by The Plan Portal 2025
For Illustrative Purposes Only.

